

CHAMBERLAIN®

The Safety Sensor Kit is compatible with Chamberlain® Gate Access Systems GA400D, GA420D, and GA200D. The Safety Sensors are designed to detect an obstacle in the path of the electronic beam and stop the gate operator.

CARTON INVENTORY

Verify carton inventory below.

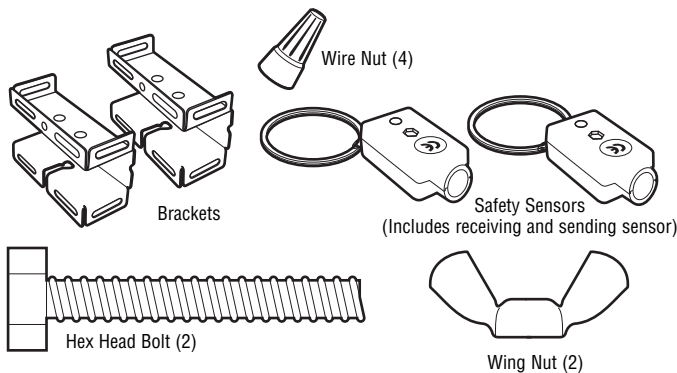

IMPORTANT INFORMATION ABOUT THE SAFETY SENSORS

When properly connected and aligned, the sensor will detect an obstacle in the path of its electronic beam.

The sensors must be installed so that the sending and receiving eyes face each other across the gate, no more than 24" (61 cm) above the ground. The sensors can be installed on the left or right of the gate as long as the sun never shines directly into the receiving eye lens.

The safety sensors must be securely fastened to a solid surface such as metal or a treated wood post (not provided). The light beam path must be unobstructed during normal operation of the gate.

NOTE: Due to the variety of gates and mounting applications, PVC conduit, wire, mounting hardware and posts are not provided. Refer to your local hardware store for additional hardware.

APPLICATIONS

ENTRAPMENT SAFETY SENSORS

This will pause an opening gate until the obstruction has been removed. Upon removing the obstruction, the gate will continue to open. This will have no effect on the gate closing.

OPEN (PHOTO EYE/IR) SAFETY SENSORS

- **GA400D/GA420D** - This will pause an opening gate until the obstruction has been removed. Upon removing the obstruction, the gate will continue to open. This will have no effect on the gate closing.
- **GA200D** - This will stop a closing or opening gate, once the obstruction is removed the gate will continue to operate normally upon the next command given.

CLOSE (PHOTO EYE/IR) SAFETY SENSORS

- **GA400D/GA420D** - This will reverse a closing gate to the full open position (open limit). This will have no effect on a gate opening.
- **GA200D** - This will stop a closing or opening gate, once the obstruction is removed the gate will continue to operate normally upon the next command given.

THE PROTECTOR SYSTEM® SAFETY SENSORS MODEL 916GA

⚠️ ⚠️ WARNING

To prevent **SERIOUS INJURY** or **DEATH**:

- Disconnect **ALL** electric and battery power **BEFORE** performing **ANY** service or maintenance.
- Correctly connect and align the safety sensors.
- Install the sensor so beam is **NO HIGHER** than 24" (61 cm) above ground.
- This product is for use with Chamberlain® GA400D, GA420D, and GA200D gate operators **ONLY**.

OPEN and ENTRAPMENT Safety Sensors

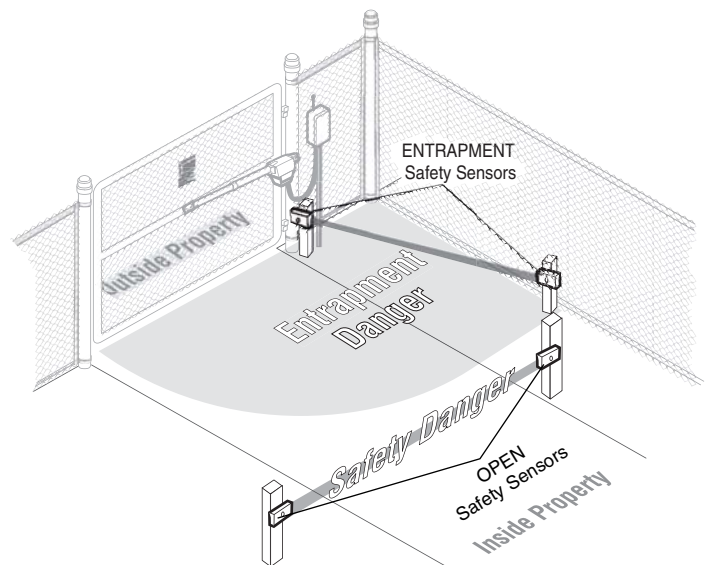

CLOSE Safety Sensors

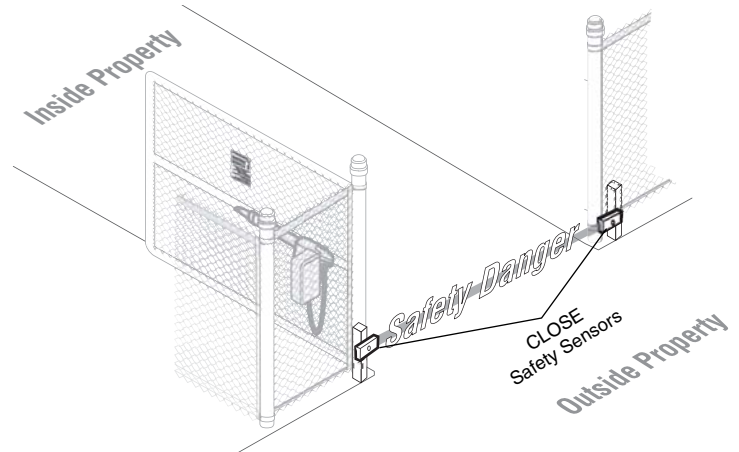

POWER

Disconnect power and batteries to the operator.

SAFETY SENSOR POSTS

Use a metal or treated wood post (not provided) to elevate the sensors. Safety sensors must be installed no higher than 24" (61 cm) above the ground.

CAUTION

To AVOID damaging gas, power or other underground utility lines, contact underground utility locating companies BEFORE digging.

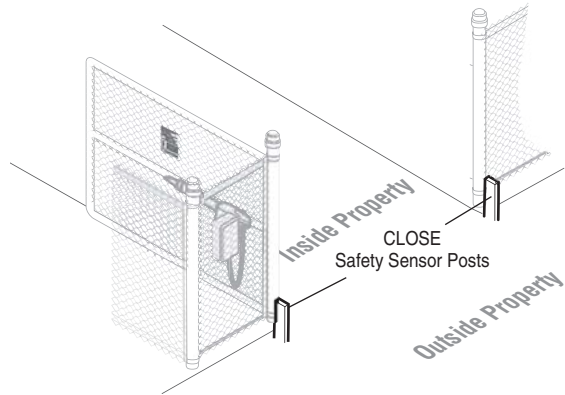
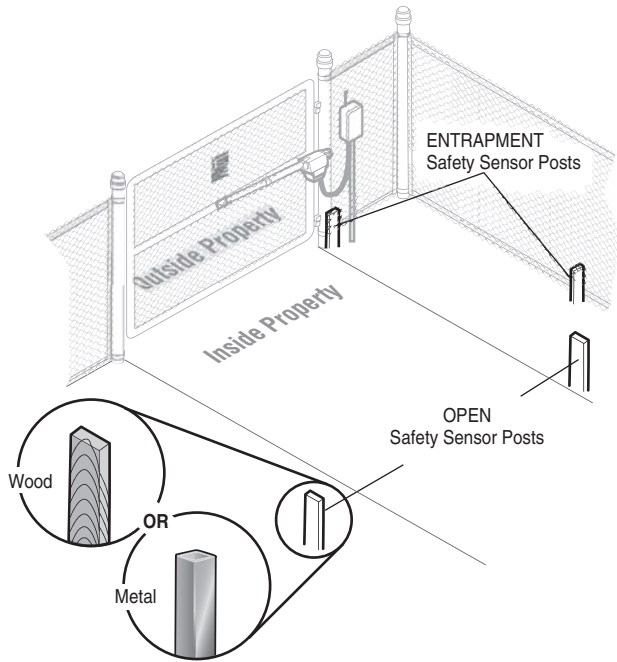

NOTE: For ideal protection the safety sensors should be installed as close to one another as possible with the maximum distance up to 30' (9.1 m).

TRENCH FOR WIRING

Before digging, contact local underground utility locating companies.

Dig a narrow trench 6" (15 cm) deep from control box to safety sensor posts. Be careful not to damage any buried wire. Run conduit from control box to safety sensor posts and run low voltage wire* (not provided) through conduit.

OPEN SAFETY SENSORS

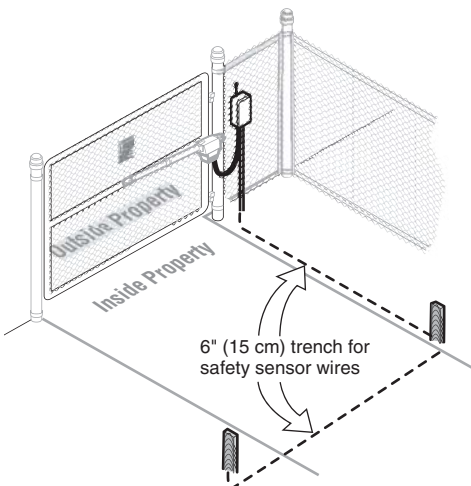

ENTRAPMENT SAFETY SENSORS

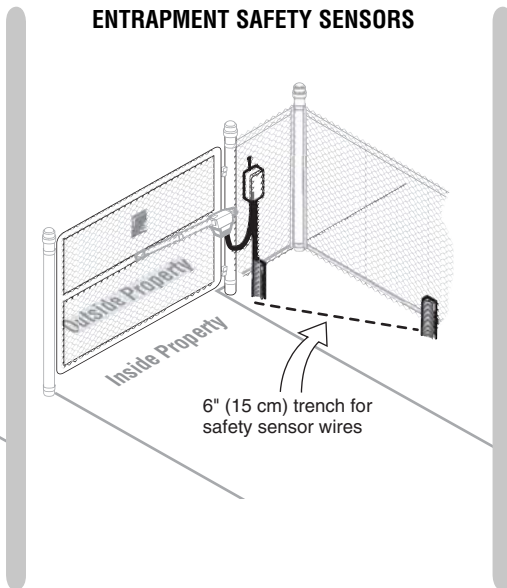

CLOSE SAFETY SENSORS

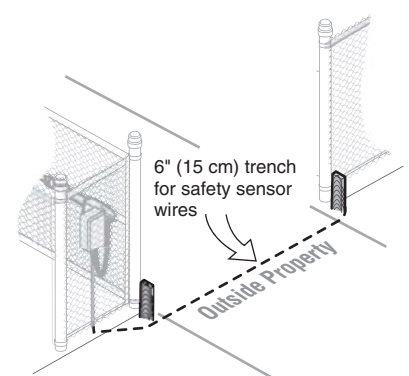

*UL approved Class 1 or Class 3 direct burial/underground, sunlight/UV resistant 16 gauge 2-conductor/standard wire.

ASSEMBLE SAFETY SENSORS

Insert hex head bolt through safety sensor and slide safety sensor into bracket. Secure with wing nut.

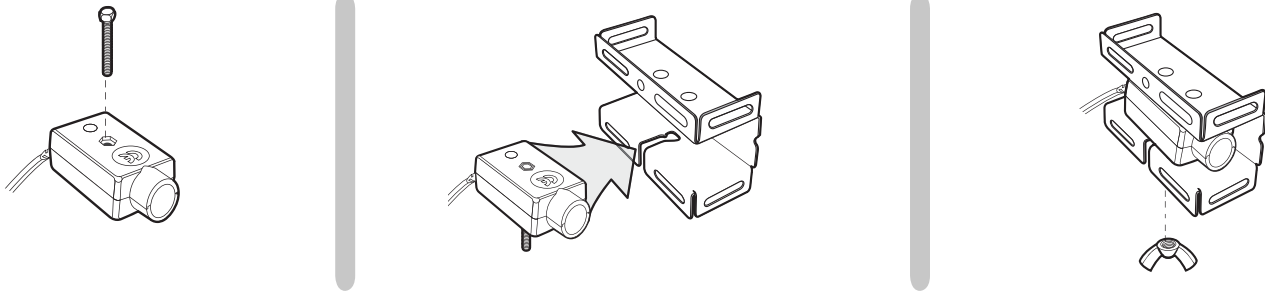

MOUNT SAFETY SENSORS

Mount safety sensor assembly to post using appropriate hardware (not provided). Safety sensors must be installed no higher than 24" (61 cm) above the ground.

NOTE: Install safety sensor assembly with the two holes in the bracket facing up and the LEDs visible at the top.

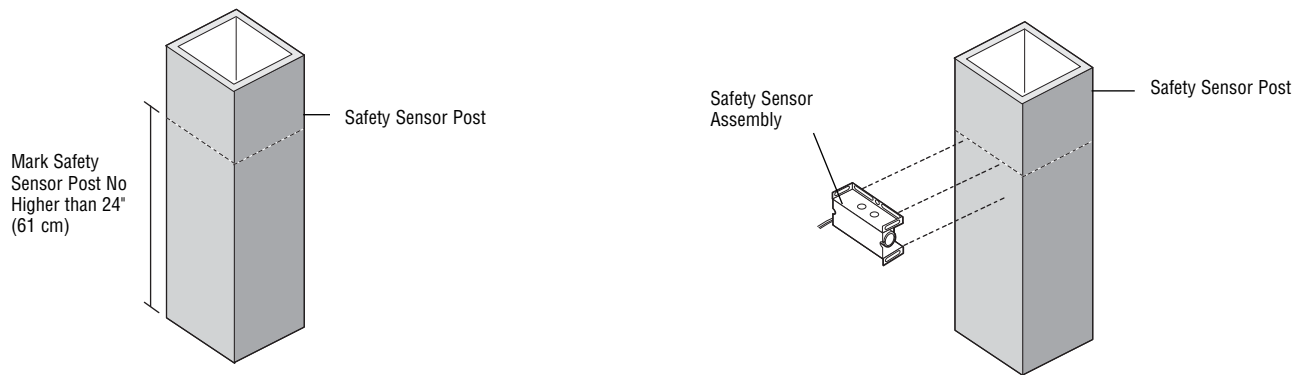

WIRE SAFETY SENSORS

1. Separate wires.
2. Strip 7/16" (11 mm) of insulation from low voltage wires.
3. Combine all like-colored wires and twist together with wire nuts.

